

## Overview

The Repeater Set is designed for extending the range of Liftmaster Wireless Products. The Repeaters create a secure, reliable connection between wireless devices at greater distances, without the need for wiring. They are recommended for use with buildings with stucco or cement walls.

**NOTE:** Universal wireless only supports 1 set of repeaters on installation of the Indoor Telephone Interface and 2 sets of repeaters on installations with Portable Intercoms.

## Carton Inventory

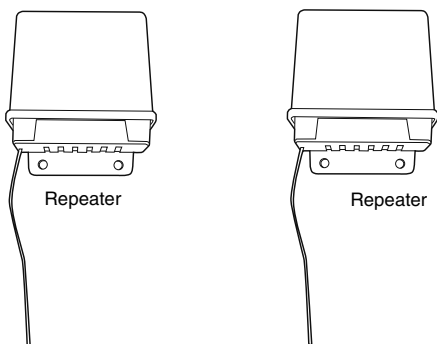

## Assembly

### Step 1

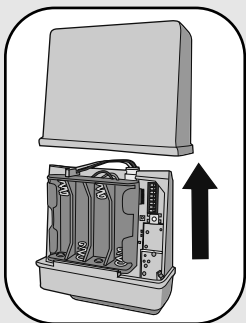

Remove cover.

### Step 2

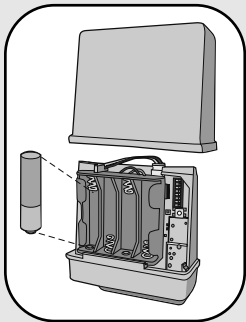

Install 4 AA Alkaline batteries (not provided). (Lithium batteries recommended for colder environments.)

## Optional External Power

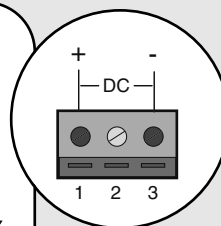
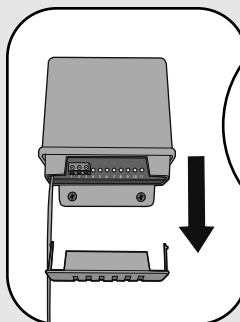

10-24 Vdc 100 mA minimum

## Setting Identity

### Step 3

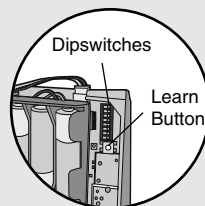

On **ONE** Repeater, set Dipswitch #1 to ON. All other Dipswitches should remain OFF.

## Program Primary Device

### Gate Access Panel (GAPLM)

**NOTE:** All accessories or secondary devices must be programmed to a Repeater that has been programmed to a primary device (like the GAPLM or DAILM). Do NOT program any accessory other than a GCU, Receiver, or Remote Control Transmitter to the primary device because it will bypass the Repeaters and will not function.

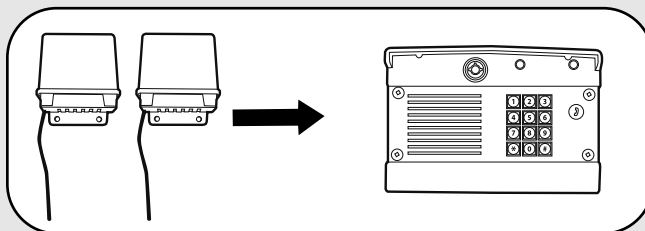

**Step 1:** Press Learn button on both Repeaters (within 5 seconds of each other). LED will light.

**Step 2:** Within 20 seconds enter Master PIN Number on GAPLM.

**Step 3:** Press "05".

The LEDs on the Repeaters will flash 3 times indicating programming is successful. Allow GAPLM 30 seconds to time-out of Learn Mode, or press the "\*" to end Learn Mode before proceeding.

**NOTE:** If LED on Repeater blinks 12 times, the programming failed.

## DAILM/FDI

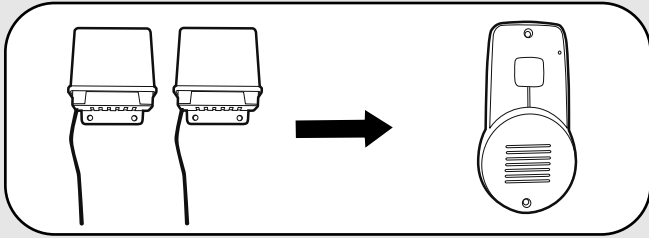

Verify that Dipswitch #1 is in the DOWN position, setting the DAILM/FDI as the Primary device. To clear memory on the DAILM/FDI press the Learn button until a tone is heard.

**Step 1:** Press Learn button on both Repeaters (within 5 seconds of each other). LED will light.

**Step 2:** Press the Learn button on the DAILM/FDI until a beep is heard.

The LEDs on the Repeaters will flash three times indicating programming is successful.

**NOTE:** The DAILM/FDI will beep until it is out of Learn Mode.

## Second Repeater Set

### NOTES:

- The second Repeater Set is optional and can be used if the primary and secondary devices are still out of range with one set of Repeaters.
- When using Repeaters with a GAPLM and an Intercom, there can only be a maximum of two sets of two Repeaters.

**Step 1:** Press Learn button on both Repeaters (within 5 seconds of each other). LED will light.

**Step 2:** Press Learn button on **ONE** of the **first** set of Repeaters. LED will light.

**Step 3:** The LED's on the second set of Repeaters will flash three times indicating programming is successful.

### NOTES:

- If LED on Repeater blinks 12 times, the programming failed.
- Wait one minute after programming second set of Repeaters before programming accessories.

Accessories can now be programmed to the second set of Repeaters. Program the accessory to **ONE** of the Repeaters. Any other accessories can be programmed to either the accessory that was just programmed or the same Repeater.

## Program Secondary Device

When programming Repeater to accessories, the accessory should be programmed to only **ONE** of the Repeaters.

### Portable Intercom

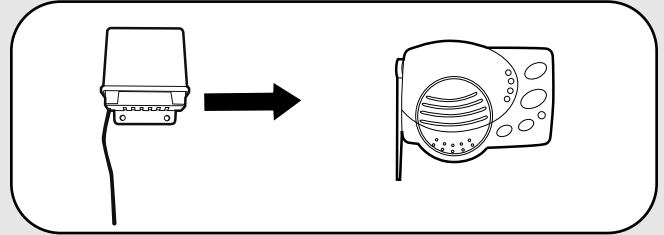

To clear Intercom memory, press and hold the Learn button until you hear a beep.

**Step 1:** Press the Learn button on the Portable Intercom until a beep is heard.

**Step 2:** Press the Learn button on **ONE** Repeater. LED will light.

The Portable Intercom will beep indicating programming is successful.

**NOTE:** The Intercom will beep until it is out of Learn Mode.

### Indoor Telephone Interface (OTIU)

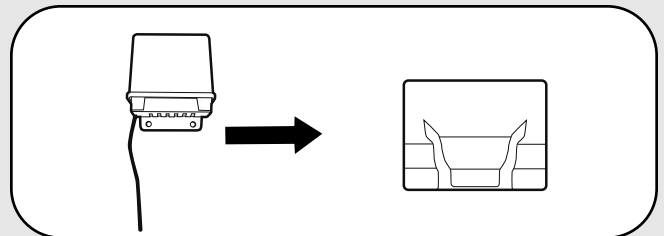

To clear the memory on the OTIU, dial “\*\*#8” on the telephone connected to the OTIU. A beep will be heard.

**Step 1:** On the phone connected to the OTIU, press “\*\*07” after hearing the dial tone. Hang up and Learn LED will flash for 15 seconds.

**Step 2:** Press the Learn button on **ONE** Repeater. LED will light.

The LEDs on the Repeaters will flash three times indicating programming is successful. The OTIU will ring the telephone and Caller ID will display “Unit Learned”.

## Flush Mount Intercom

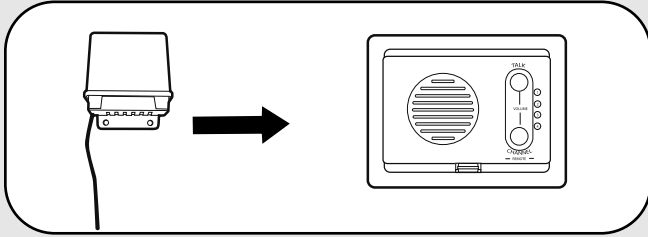

To clear Intercom memory, press and hold both buttons until you hear a tone (about 20 seconds).

**Step 1:** Press and hold both the Talk and Channel buttons on the Intercom for 3 seconds. The Channel LEDs will cycle through, flashing rapidly.

**Step 2:** Within 10 seconds press the Learn button on **ONE** Repeater. LED will light.

The Flush Mount Intercom will beep indicating programming is successful.

**NOTE:** The Intercom will beep until it is out of Learn Mode.

## DAILM/FDI

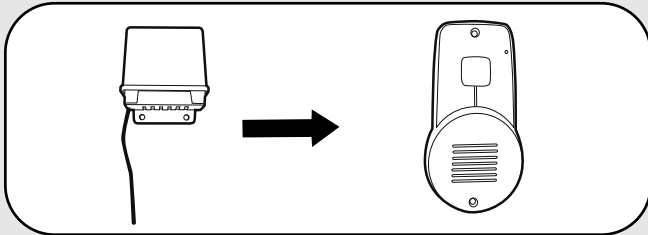

Verify that Dipswitch #1 is in the UP position, setting the DAILM/FDI as a Secondary device.

To clear memory on the DAILM/FDI press the Learn button until a tone is heard.

**Step 1:** Press the Learn button on the DAILM/FDI until a beep is heard.

**Step 2:** Press the Learn button on **ONE** Repeater. LED will light.

The DAILM/Intercom will beep indicating programming is successful.

**NOTE:** The DAILM/FDI will beep until it is out of Learn Mode.

## Gate Access Panel (GAPLM)

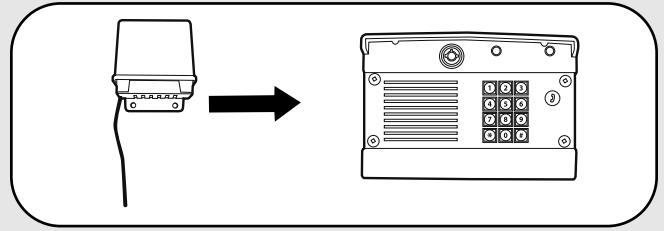

**NOTE:** A GAPLM can be used as an accessory to the Primary GAPLM.

**Step 1:** Press the Learn button on **ONE** Repeater. LED will light.

**Step 2:** Within 20 seconds enter Master PIN Number on the secondary GAPLM.

**Step 3:** Press "56".

The LED on the Repeater will turn off indicating programming is successful.

**NOTE:** If LED on Repeater blinks 12 times, the programming failed.

## Mount Repeaters

### Step 1

Choose location to mount Repeaters. Repeaters should be half-way between the two devices (devices can be no further than 1000' apart). Repeaters need to be mounted side-by-side between 10' - 40' apart. Refer to example below.

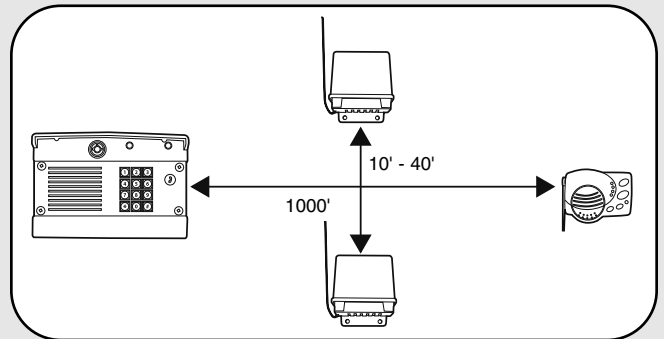

### Step 2

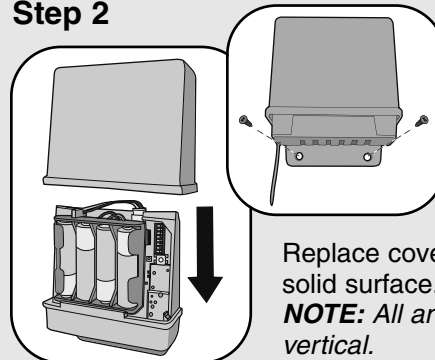

Replace cover and mount to solid surface.

**NOTE:** All antennas should be vertical.

## Troubleshooting

### **Repeaters are not getting expected transmission range.**

Keep Repeaters away from trees, metal objects and electrical wiring. Do not mount Repeaters on trees, masonry, or metal surface.

Ensure that the Repeaters are mounted between 10' - 40' apart. On ONE Repeater the Dipswitch needs to be set to the UP Position and the Dipswitch on the other Repeater needs to be set to the DOWN position. If the Repeaters are set to the same Identity or close to each other, they will interfere with each other and limit range.

When used in buildings with stucco or cement walls, the range is greatly reduced. Repeaters can be used close to the building to solve this problem.

**FOR TECHNICAL SUPPORT DIAL OUR TOLL FREE NUMBER:**

**1-800-528-2806**

**[www.liftmaster.com](http://www.liftmaster.com)**

NOTICE: To comply with FCC and or Industry Canada rules (IC), adjustment or modifications of this receiver and/or transmitter are prohibited, except for changing the code setting or replacing the battery. THERE ARE NO OTHER USER SERVICEABLE PARTS.

Tested to Comply with FCC Standards FOR HOME OR OFFICE USE. Operation is subject to the following two conditions: (1) this device may not cause harmful interference, and (2) this device must accept any interference received, including interference that may cause undesired operation.